

VALOI

easy120

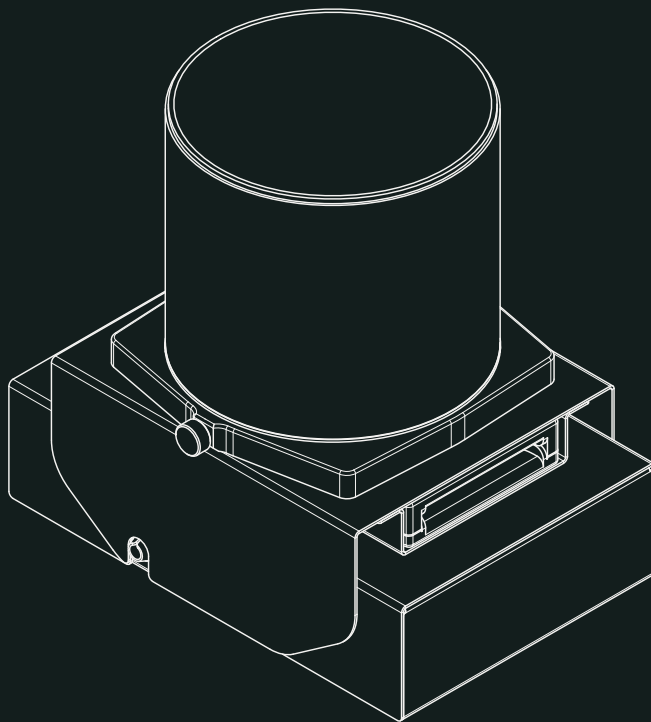

International

Download the manual in other languages

This manual or a shortened version is available online in different languages, please visit:

www.valoi.co/easy120-manual



Manual available here.
Handbuch hier verfügbar.
Handleiding hier beschikbaar.
Manual disponible aquí.
Manuel disponible ici.
Manuale disponibile qui.
Manualen finns här.
РЪКОВОДСТВОТО Е ДОСТЪПНО ТУК.
Priručnik dostupan ovdje.
Příručka k dispozici zde.
Manualen er tilgængelig/tilgjængelig her.
Vadovas prieinamas čia.

Εγχειρίδιο διαθέσιμο εδώ.
Kézikönyv elérhető itt.
Lámhleabhar ar fáil anseo.
Rokasgrāmata pieejama šeit.
Manwal disponibbli hawn.
Instrukcja dostępna tutaj.
Manual disponibil aqui.
Manualul disponibil aici.
Käsiraamat on siin saadaval.
Käsikirja saatavilla täältä.
Príručka dostupná tu.
Priročnik na voljo tukaj.

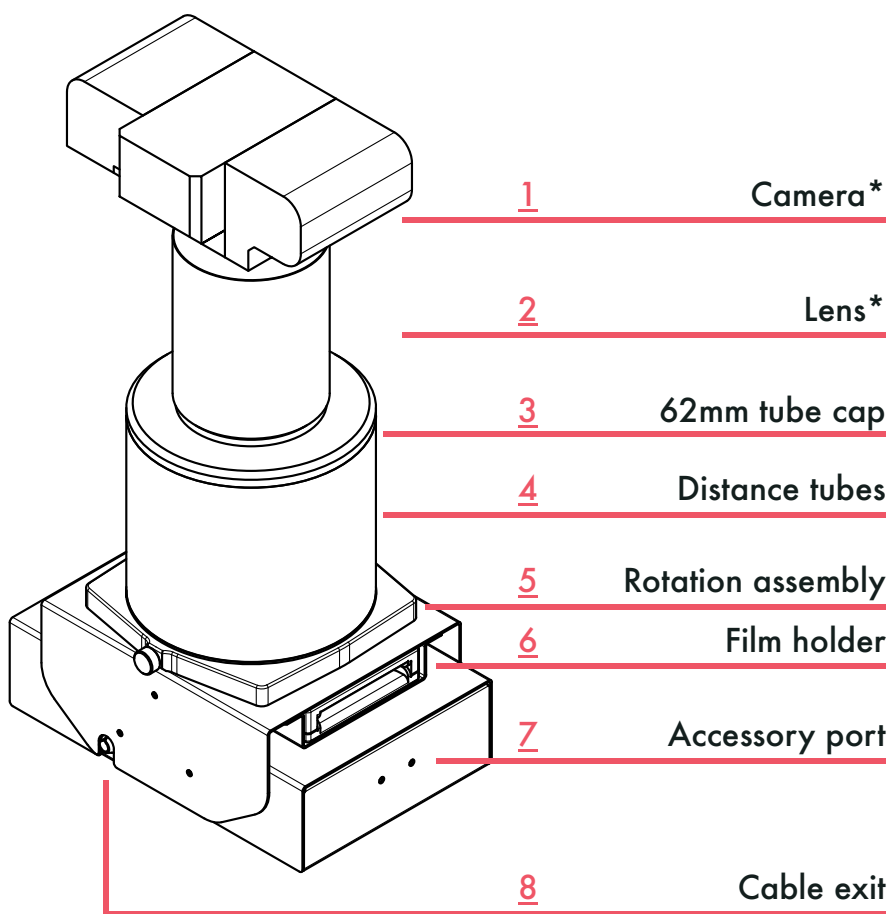

Table of Contents

Overview	4
Warnings	6
Environmental	7
First time use	8
Available accessories	10
Using accessories	11
Scanning	12
Post-Processing	18
Scanning Slides	19
Further resources	20
Product details	21



Overview



CS-LITE LED light source inside

* Not included in kit

** The easy120 should only be used as shown here in some cases, see page 12

4



Overview

1. Camera: Not supplied with the kit.
2. Lens: Not supplied with the kit. See www.valoi.co/easy120 for information about suitable cameras and lenses
3. 62mm tube cap: Adapter from the tube thread to normal filter threads
4. Distance tubes: Creates the distance from the front of the lens to the easy120 body unit
5. Rotation assembly: Allows you to rotate and lock the rotation for perfect framing. Thumb screw lock.
6. Film holder: Interchangeable holders
7. Attachment point (on both sides) for accessories (page 10)
8. Cable exit (fixed, not shown in drawing)

Contents of the box

- VALOI easy120 main unit
- Distance tube set: 2x 100mm, 1x 50mm, 1x 25mm, 1x 12mm, 1x 62mm tube cap
- Filter thread adapter set: 39mm, 46mm, 49mm, 52mm, 55mm, 58mm, 62mm, 67mm, 72mm, 77mm
- 120 6x9 Universal film holder
- Camera riser block (see page 13)
- Instruction manual
- CineStill CS-LITE built-in light source (power supply not included)

Please read this manual carefully in order to avoid damage to the equipment, peripheral equipment, or harm to yourself or others.



Warnings

- **IMPORTANT:** When the easy120 is attached to a lens and camera, always lift both the unit and camera/lens together with both hands. Lifting from a single point can cause damage to your lens and/or camera.
- If the device becomes hot or overheated, turn it off immediately and unplug it from the power supply. The product **does not** contain a battery, and in the event of a fire, normal fire fighting measures are effective.
- Please see separate instructions for the CineStill CS-LITE Light source built into this device.
- **Avoid** using AUTOFOCUS on your camera if the lens has an external focusing mechanism (the lens barrel extends when focusing). **Using autofocus on such a lens may damage it.**
- Avoid using this device in extreme heat or extreme cold.
- Avoid this device getting wet or storing it in a humid environment.
- The standard holders for the easy120 cannot be used to scan single-frame images of any format. There can also be a noticeable decrease in film flatness on the first and last frame of the film.
- Contains small parts, **keep away from children.**



Environmental

Disposal and replacements

The VALOI easy120 is made from materials that will last decades if used properly. Spare parts will be available for this model for no less than 5 years after your purchase. Please get in touch with:

Kameratori Oy

Erkkiläkatu 11B, 33100 Tampere, Finland

info@kamerastore.com / hello@valoi.co / +358 10 2311777

Responsible: A. E. Båsmo

Materials: All outer body parts and tubes are made from aluminium, either powder coated or anodised. Some internal parts are made from either Nylon 12 (holders), TPU (cable guard) or PLA (spring housing) plastic.

Electronics: This product contains a CineStill CS-LITE (UPC: 4260243555033,) which is fully user replaceable.

Power: 10W, Working temperature: -10°C to 50°C, Power

supply: 5V, 1.6A, USB-A direct input, Light beads: 108pcs

Note that safety information for this is included in a separate manual.

Disposal: Dispose of this product according to local regulation for cardboard, metals (aluminium, steel), plastics and electronics. This device does not contain any batteries of any kind.



First time use

Limitations

The easy120 is a flexible and durable tool with the potential for professional-grade scanning at home.

The results will depend on your lens and camera. Not all lenses and cameras are compatible. You can find up to date recommendations for lenses at:

www.valoi.co/easy120-lens

The working distance for the desired scanning format and lens combination must be shorter than 310mm. Working distance refers to the distance between film and front of the lens.

Typical compatible macro focal lengths for scanning 120 film:

Digital medium format: 120mm, Full-frame: 105mm, APS-C: 80mm, MFT: 60mm

The easy120 is supplied with a holder intended to optimise speed and quality for roll film and strips of film.

The standard holders for the easy120 cannot be used to scan single-frame images of any format or **any strip of film shorter than 16cm (6.3")**. There can also be a noticeable decrease in film flatness on the first and last frame of the film. Additional holders may be available in the future for these special use cases.



First time use

Finding the right tube lengths

The first time you use the easy120, it is a good idea to find out which combinations of distance tubes you will use. Follow the steps below for each format:

1. Remove all tubes from the easy120, insert the holder and insert the film. Turn on the light source.
2. Hold the camera above the film. Move the camera towards or away from the film while focusing until you see the whole frame in focus through the camera.
3. You now have the approximate distance you need. Take note or measurement of this distance from the front of the lens to the top of the easy120 unit.
4. Using the distance tubes, build a stack of tubes until you get to the measured distance. You might have to adjust this later.
5. Add the 62mm tube cap to the top of the distance tubes, and the filter thread adapter needed for the lens. Screw your lens and camera onto the stack.
6. Now you should be able to focus on the film. Check the framing and adjust accordingly, by adding (if you don't see the edges of the frame) or removing (if you see too much border around the frame) tubes.

Note that you are not guaranteed to get a perfect frame around the film. We recommend over scanning slightly and cropping as this has minimal impact on quality.



Available accessories

As of November 2024

The easy120 is a modular system with additional accessories available. These are available from VALOI/Kamerastore.com directly or from any retailer carrying the product.

Please visit the page for the latest available accessories:

www.valoi.co/easy120

- easy120 120 6x7 Holder
- easy120 120 6x6 Holder
- easy120 120 6x4.5 Holder
- easy120 35mm Standard Holder
- easy120 35mm Panoramic Holder
- easy120 Advancer Unit
- easy120/360 Duster Anti-static brush attachment

The included easy120 6x9 Universal holder is available separately upon request.

See valoi.co/buy for an up to date list of retailers for purchase of further accessories.



Using accessories

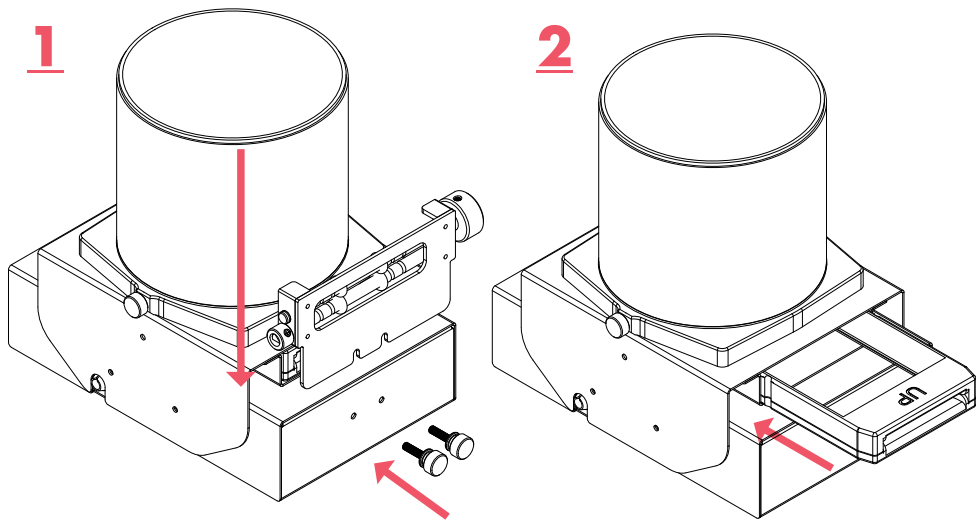

1. Using the accessory port

The easy120 is designed with one accessory port on each short end. These can be used to attach current and future attachments such as the Duster and Advancer.

Screw in the M4 thumb screws (included with accessories) most of the way in, place the accessory down onto the screws and tighten them.

2. Replacing the holder

The easy120 has a spring-ball system to keep holders in place. To remove the installed holder, simply push on either side until it comes out. Remove the holder.

Replace the holder by orienting UP in the upwards direction and push the holder in until it clicks. The holders are bi-directional.



Scanning Setup

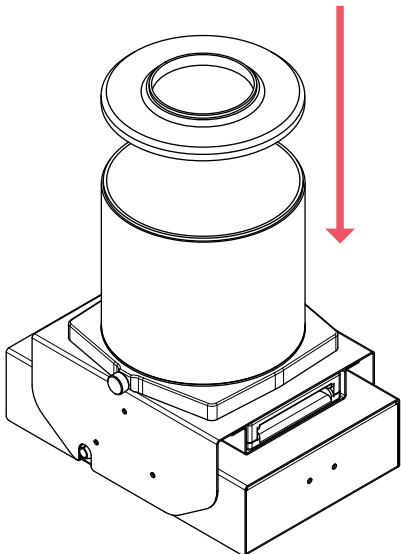

With the correct number of tubes, add the 62mm adapter plate on-top, where the correct filter thread adapter can then be added.

You are now ready to attach the lens and camera.

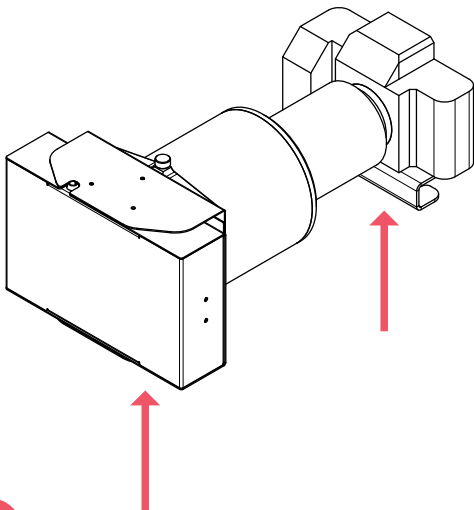

Warning: Always support the camera and easy120 unit with both hands when lifting it. Failing to do so may damage the lens or camera.

12



Scanning

Scanning orientation

To safely and accurately scan with the easy120, choosing the appropriate scanning orientation is important.

Horizontal position

This is the main position for scanning and should be used with any lens that has an externally focusing helicoid (ie. the lens barrel gets longer when you focus).

Ensure the thumb screw and cable face upwards to avoid damage.

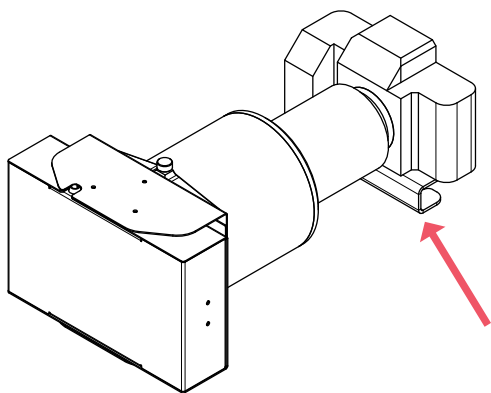

Tip: When scanning horizontally, attach the included camera riser in the tripod socket to level out your camera.

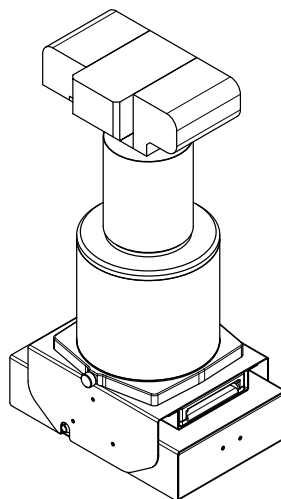

Vertical Position

Only use the unit vertically if the lens has internal focus. Externally focussed lenses will sag/drift in this configuration.



Scanning

Changing the holder and insert film

The holders for the easy120 system are interchangeable and simply click in place in the right spot.

- Remove the holder by pushing it out in either direction.
- Locate the "UP" found on the holder. This should be facing upwards when the easy120 device is standing like a chimney.
- Push the holder in until you hear and feel a click. The holder is now located.
- To scan, insert film from either side of the holder. Push the film through until you see the first frame.
- Please see directions about emulsion side on the next page.
- Always try to align the frames in the same location inside the holder to avoid manual cropping later.

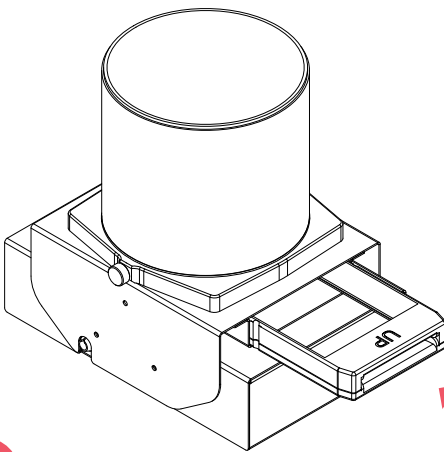

Once holder located,
insert film as shown

14



Scanning

Selecting holder and emulsion direction

Do I need a special holder for my 120 medium format film?

The easy120 comes with a Universal holder for 120 film which can be used up to 6x9 frames. This can be used on all formats.

Choosing a specialised holder for each film format *can* improve film flatness by making the film track between S-curves shorter. It *may* also improve scanning contrast by masking off extraneous light.

Should I scan emulsion side up or down?

The film is perfectly transparent and scanning 'through' the base will not reduce sharpness. The only impact on quality is film flatness.

In most cases, you will achieve better film flatness scanning with the emulsion side away from the camera. However, films curve differently and you may achieve flatter results with the emulsion side facing the camera. Please test this for your specific film and adjust accordingly.



Scanning

Camera settings

Before scanning, please check the following settings on your camera:

1. Uncompressed or lossless RAW mode
2. ISO: 100 (or lowest native ISO of camera)
3. White balance: Automatic (this does not influence the final result but is useful for better judging exposure)
4. Manual focus: Recommended for external-focusing lenses (where the lens barrel extends to focus) as using auto focus may damage the lens.
5. Manual setting alternative *
 1. Aperture f/5.6-f/8
 2. Shutter speed: Approximately 1/30
6. Aperture priority setting alternative **
 1. Aperture f/5.6-f/8
 2. 1+ Exposure compensation
7. Live view + focus magnification for checking framing and focusing

*Manual setting will be more suitable if you have a newer camera with higher dynamic range. Using a consistent exposure across a full roll of film will help get a consistent colour and contrast in the final images

**Aperture priority settings will be more suitable for older cameras where you should optimise the use of the sensors dynamic range.



Scanning

Capture

Once the scanning setup is ready, insert film into the film holder. Capture the first frame and then move on to the next frame by pushing or pulling the film

- We recommend you **scan with the emulsion facing the light source**, but in some cases better flatness is achieved with the emulsion facing the lens.
- You should aim to place the film in the same place each time. Use a grid-line on the camera to guide your scanning. This will ensure you can crop all the images at the same time when post-processing
- Always recheck focusing at the start of a roll, as it might drift over time.
- Use a shutter remote where possible.
- We recommend using a tethering software with your camera to import images, if available.

Once you have finished capturing your images, import the files to a computer and process them according to the recommendation on the next pages.



Post-Processing

General recommendation

The easy120 is equipped with a high-colour rendering light source, but the quality of your results will depend on your post processing.

We recommend you always use vignetting compensation/flat-field correction to compensate for unevenness in the optical system.

We recommend the following pieces of software for converting negatives to positives:

- Adobe Lightroom + Negative Lab Pro
- FilmLab App
- Photoshop + Grain2Pixel
- Photoshop + Negmaster

For processing slides (positive film), we recommend professional image editing software like Adobe Lightroom or Capture One.



Scanning Slides

Specific instructions for slides:

- Scanning mounted slides requires an additional holder, sold separately. Visit our website for the most up to date information.
- The exposure is important - in most cases it is best to use a manual setting. Remove the film and adjust the shutter speed until the light source is completely white, then reduce the exposure by 1/3-EV
- Use a linear or "neutral" profile in the camera and editing software.
- Set the white balance based on the light source, then adjust each frame individually.



Further resources

Links to useful articles

- valoi.co/post/calibrating-light-falloff
- valoi.co/post/how-to-scan-slides-or-positive-film
- valoi.co/post/how-to-choose-the-right-exposure-when-scanning
- valoi.co/post/foundations-of-thinking-in-colour
- valoi.co/post/valoi-dust-management

See valoi.co/buy for an up to date list of retailers for purchase of further accessories.



Product details

VALOI

Product name: VALOI easy120

Production batch: See sticker under easy120

Light source: Cinestill CS-LITE bi-colour LED

Power source: 5V, min. 1.6A USB-A

Spare parts available on request

For spare parts, support or feedback, please contact
hello@valoi.co or info@kamerastore.com.

VALOI is a registered trademark of Kameratori Oy.

Erkkiläkatu 11
33100 Tampere
Finland



Packaging



*For product recall, safety and
spare parts, visit
www.valoi.co/comp*

*A. Bäsma, Kameratori Oy,
Finland, 33100, Tampere,
info@kamerastore.com*

www.valoi.co

